

REV.	DESCRIPTION	ECN	DATE
B	INITIAL RELEASE	1120_ER6904	4-3-20

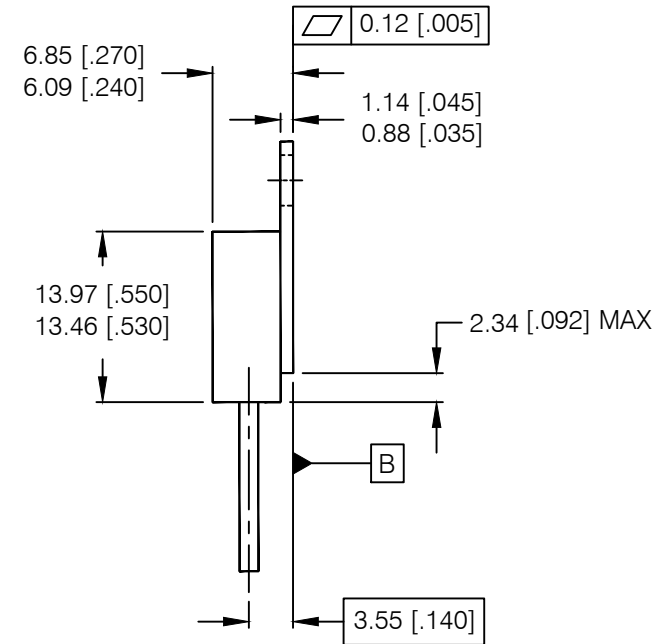
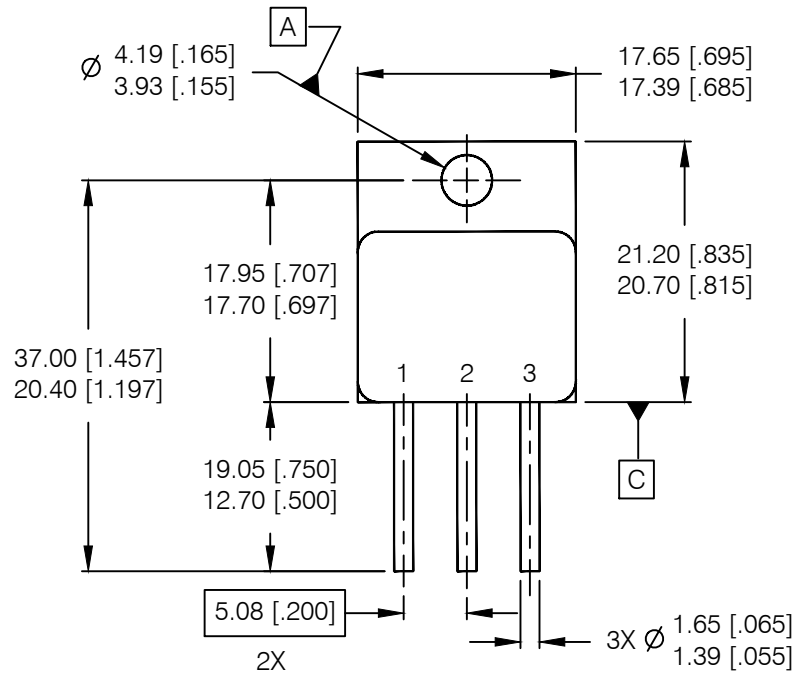

$\varnothing$	0.50 [.020]	(M)	C	A(M)	B
$\varnothing$	0.25 [.010]	(M)	C		

NOTES:

1. DIMENSIONING & TOLERANCING PER ASME Y14.5M-1994.
2. ALL DIMENSIONS ARE SHOWN IN MILLIMETERS [INCHES].
3. CONTROLLING DIMENSION: INCH.
4. CONFORMS TO JEDEC OUTLINE TO-258AA.
5. STANDARD FINAL FINISH ON ALL TERMINALS IS SOLDER ALLOY 63%Sn 37%Pb.

**IOR** HiRel  
An Infineon Technologies Company

TITLE: CASE OUTLINE: TO-258AA	
DRAWING NO. D100748G-WEB	REV B